

# INTRODUCING NOTTINGHAM VENUES



  
**NOTTINGHAM VENUES**  
— ONE DESTINATION • ENDLESS POSSIBILITIES —





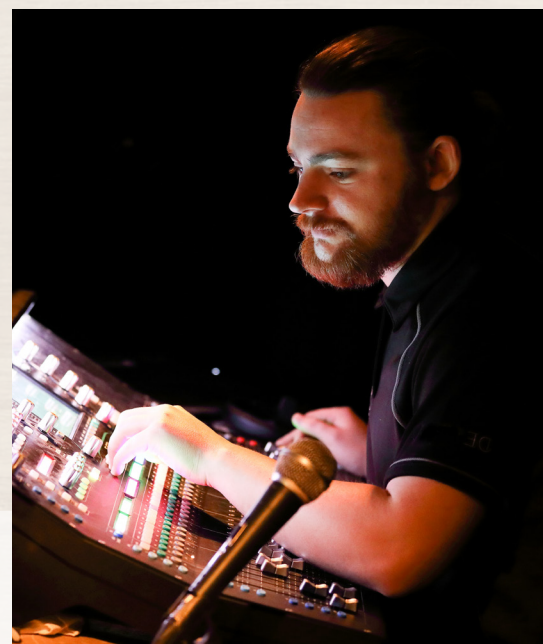
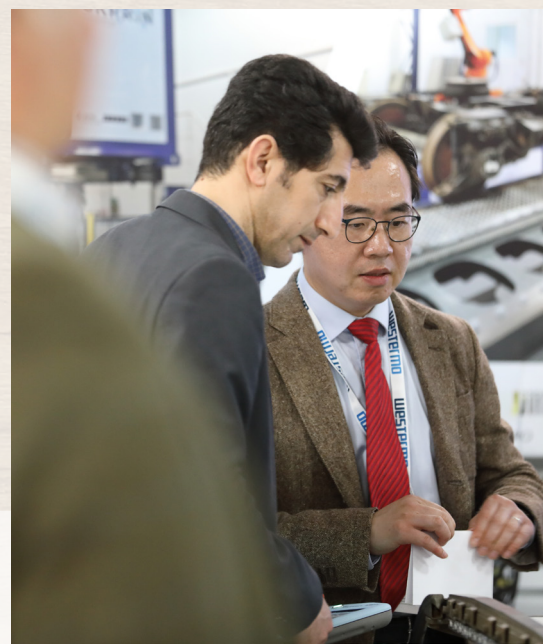

## OUR PHILOSOPHY

We are one destination with endless possibilities. We believe in creating great guest experiences. We can do this because we have one unique destination that features an unrivalled portfolio of conference venues, meeting rooms, sport facilities, hotels, cafés and restaurants.

Our unique destination enables our clients to host events with endless possibilities. Whether it's a global conference, a networking event, an overnight stay or a retreat, every booking is unique and every guest is equally important. Our only limitation is your imagination!



# SUSTAINABILITY

Sustainability is important to us. All our venues are located on the University of Nottingham campus, situated in large green spaces and the buildings are built with sustainability in mind.

We provide electric charging points, our food is sourced sustainably and locally and we separate our food waste and convert it into energy.

That's not all. The Orchard Hotel has been rated BREEAM excellent and we encourage our delegates to find more environmentally friendly ways to travel to and from events.

We provide water refill stations in our properties and we are always looking to improve our processes to ensure they're sustainable.





All our venues are located in 330 acres of suburban parkland.



We are accredited with The Green Flag Award recognising our ecological credentials.



We have installed sustainable Brita water taps in the hotel lobbies.



The Orchard Hotel is rated BREEAM excellent.

Supporting Nottingham's target to be net carbon zero by 2028.



The JCC is located around three lakes that are committed to wildlife conservation.



Our hotels feature wild bio-diverse green roof gardens to increase heat retention.



Our location includes grassland, tree clusters, shrubs, wild areas & water features.

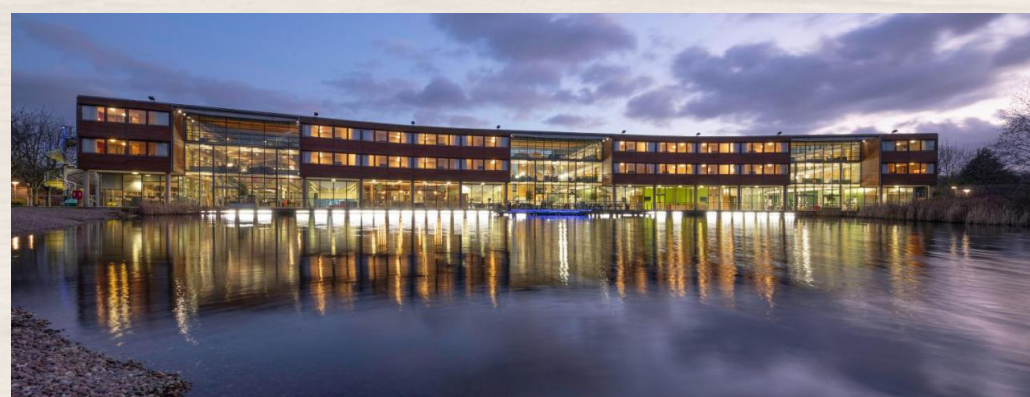

Meeting rooms and bedrooms are equipped with an extract air system.



We use organic gardening methods to encourage biodiversity.



The food waste we produce is converted into energy via our waste suppliers.



Air Handling Units use a highly efficient thermal wheel to recuperate heat.



We have built a chef's herb garden that is used daily.

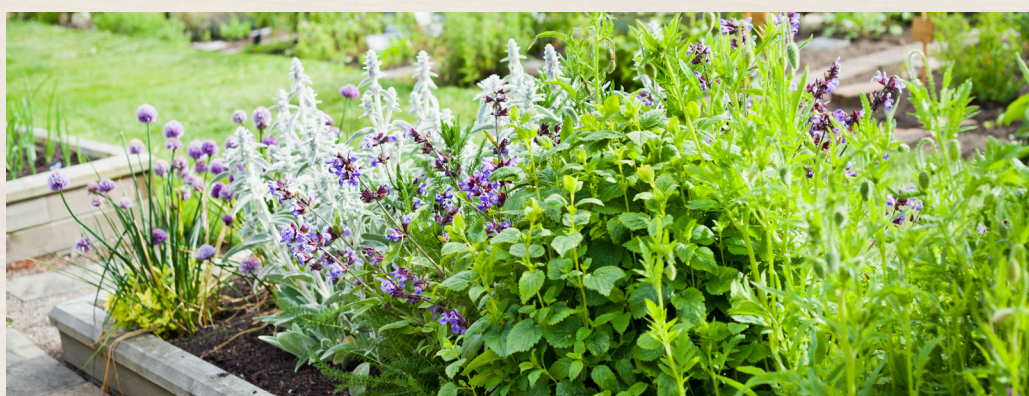

We have installed electric charging for all guests with an electric vehicle.



We encourage environmentally friendly ways of travelling to and from events.





# THE ORCHARD HOTEL & RESTAURANT

Set in 330 acres of the University of Nottingham parkland, The Orchard Hotel has 202 bedrooms, 7 meeting rooms, a brasserie and is located next to the East Midlands Conference Centre.

The building uses a range of sustainable design features, incorporating natural materials alongside high-tech renewable energy systems to deliver efficiency in use and to create an outstanding space for guests.

The Orchard Hotel incorporates 50m<sup>2</sup> of solar PV into the building to provide on-site renewable energy. The building management system ensures that only occupied rooms use heating or cooling. The hotel has beaten its target for on-site CO<sub>2</sub> emissions and this is partly down to the fact that the team use remote metering to manage energy consumption.

Our guests can enjoy a peaceful walk in our green space, an outdoor meeting with colleagues, a gym session at David Ross or a delicious meal with friends and family at Bramleys Brasserie.







## THE BRAILSFORD

This is a large event space that's used mostly for weddings, dinners, wakes, large conferences and training days. It's a flexible space that features bi-fold doors which open out onto a beautiful patio area.

It's close to the kitchen and to our hotel restaurant, making it perfect for buffets and sit down dinners. It can hold up to 100 guests in a theatre style or 40 guests as a boardroom set up.







## THE SUITES

The Russet Suite is our smallest meeting room in The Orchard Hotel. It's perfect for small meetings or as a remote working space.

As with all our meeting rooms it's equipped with a large screen and click share. The room is usually set up in a boardroom format and can seat a maximum of 10 people.

The Worcester Suite & Discovery Suite share an outdoor smart space, which gives you the option to take your meeting outside during the summer months. Both rooms are suitable for large meetings, training days, workshops and team building exercises. The Worcester Suite can hold a maximum of 50 guests theatre style and The Discovery Suite can hold 40.







# EAST MIDLANDS CONFERENCE CENTRE

The East Midlands Conference Centre is the ideal place for conferences, exhibitions, team building and meetings.

Our atrium is the central hub of the building, perfect for breakout meetings, networking and socialising.

Our conference centre has an additional 16 event and meeting spaces, offering state-of-the-art facilities. This makes it perfect for award dinners, conferences, exhibitions and training sessions.

The venue can hold up to 1,000 delegates, featuring 2000m<sup>2</sup> of exhibition space and can cater for up to 588 attendees.

Our in-house food and beverage team cater for all occasions and can create unique menus aligned to each event or season.



# EAST MIDLANDS CONFERENCE CENTRE

GROUND FLOOR PLAN

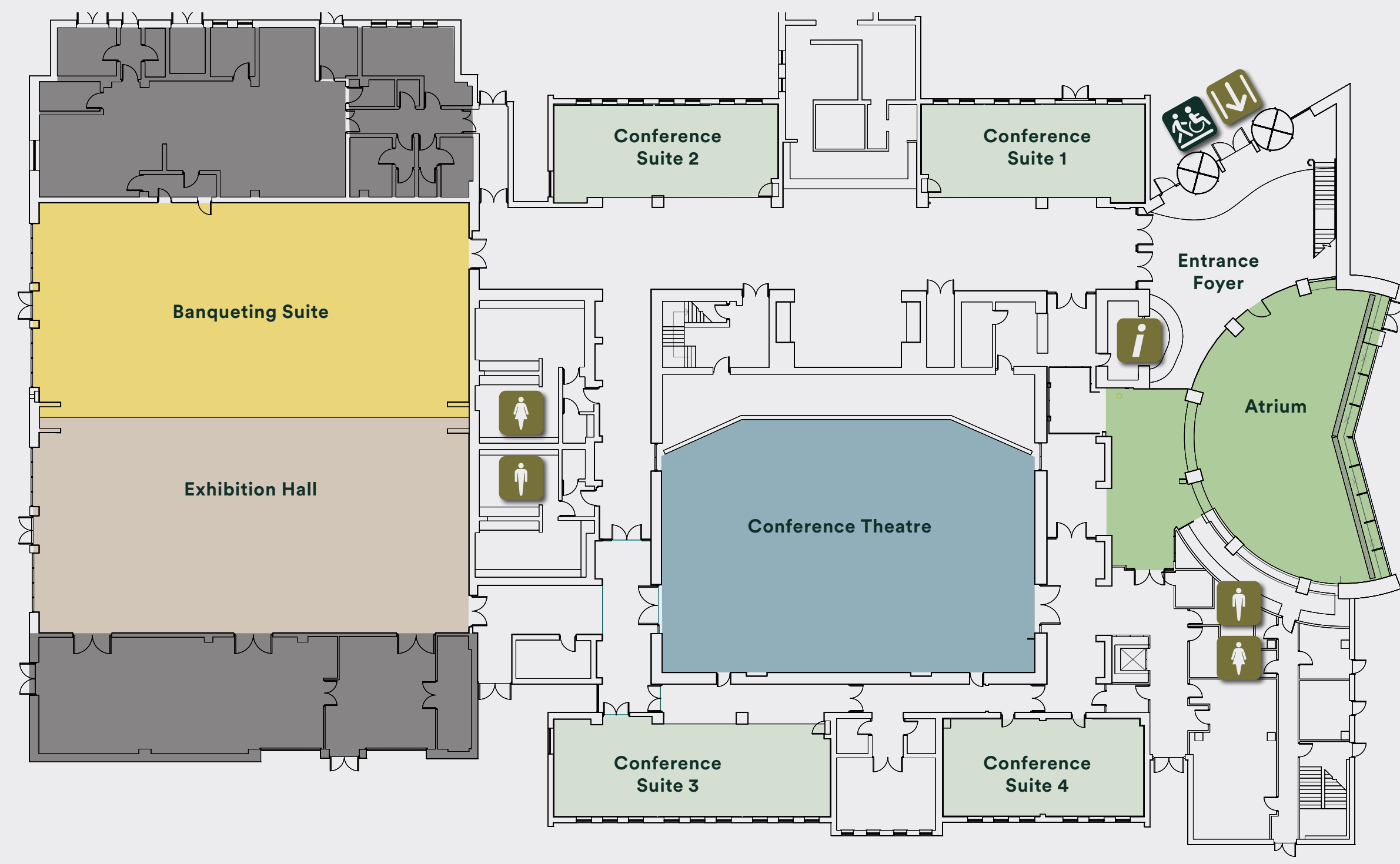

- |                            |                    |           |                       |
|----------------------------|--------------------|-----------|-----------------------|
| Atrium                     | Banqueting Suite   | Entrance  | Toilets (Male/Female) |
| Conference Suite 1,2,3 & 4 | Conference Theatre | Reception | Accessible Entrance   |
| Exhibition Hall            | Restricted Areas   |           |                       |



# EAST MIDLANDS CONFERENCE CENTRE

## FIRST FLOOR PLAN



- Conference Suite 5
- Conference Suite 6
- Events Office
- Ground Floor Foyer & Atrium
- Balcony
- Entrance
- Toilets (Male/Female)
- Restaurant/Refreshments
- Accessible Entrance





## BANQUETING SUITE

This is one of the largest spaces in the building with access to an outside courtyard. The natural daylight floods into this space, with floor-to-ceiling windows providing beautiful parkland views. This is a flexible space for exhibitions, awards dinners and seminars.

The Banqueting Suite can accommodate up to 1000 delegates in a theatre style layout.

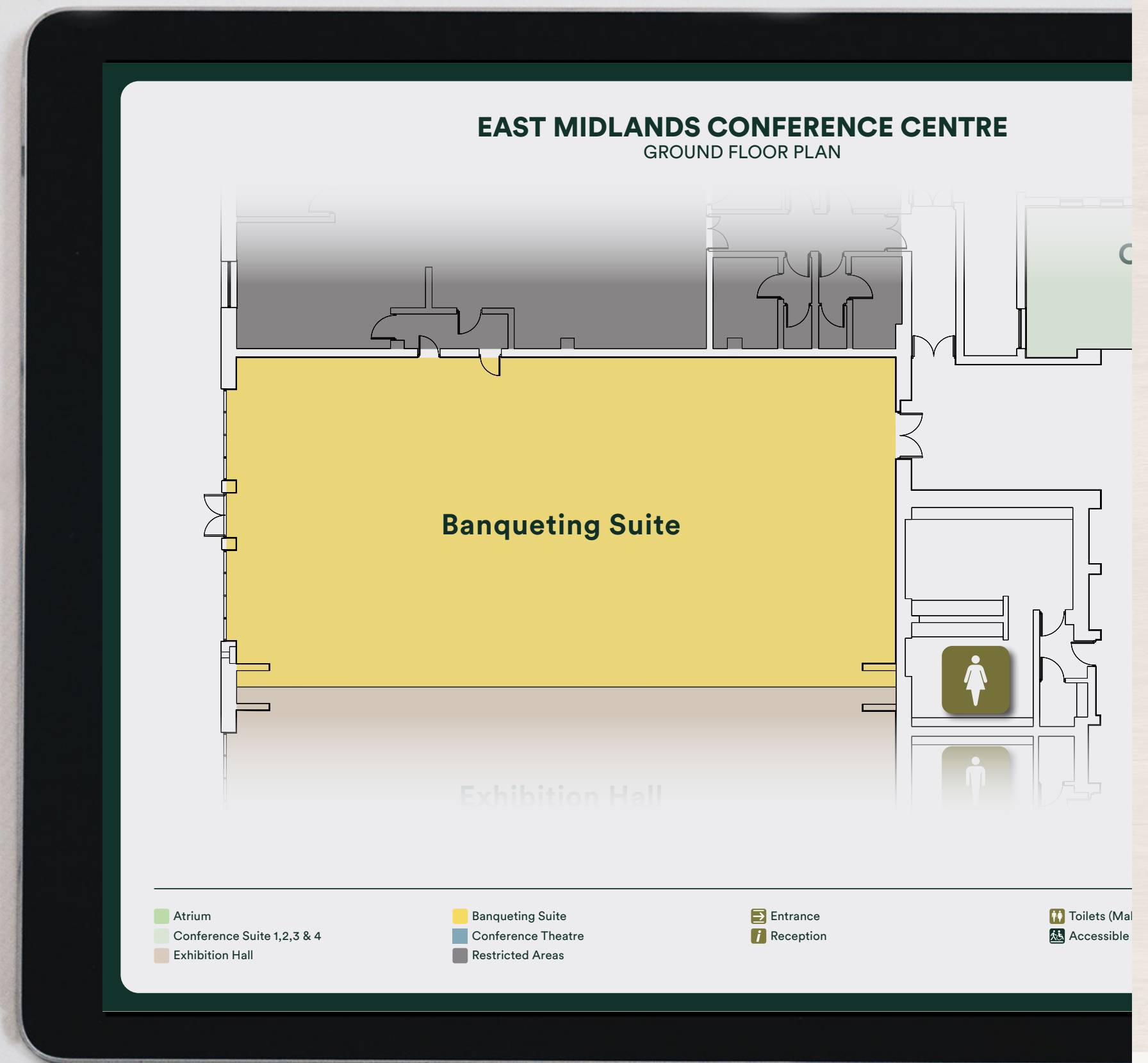





**Take your seat in  
our award winning  
auditorium.**

Complete with state-of-  
the-art AV facilities and  
retractable stage.





# CONFERENCE THEATRE

Our conference theatre was voted Best Auditorium (at the CHS Awards) for the second year in a row as well as being a finalist in the Best On-Site AV category.

This is a tiered seated auditorium for up to 520 delegates. The remote-retractable seating means the space can be easily adapted.





## EAST MIDLANDS CONFERENCE CENTRE GROUND FLOOR PLAN

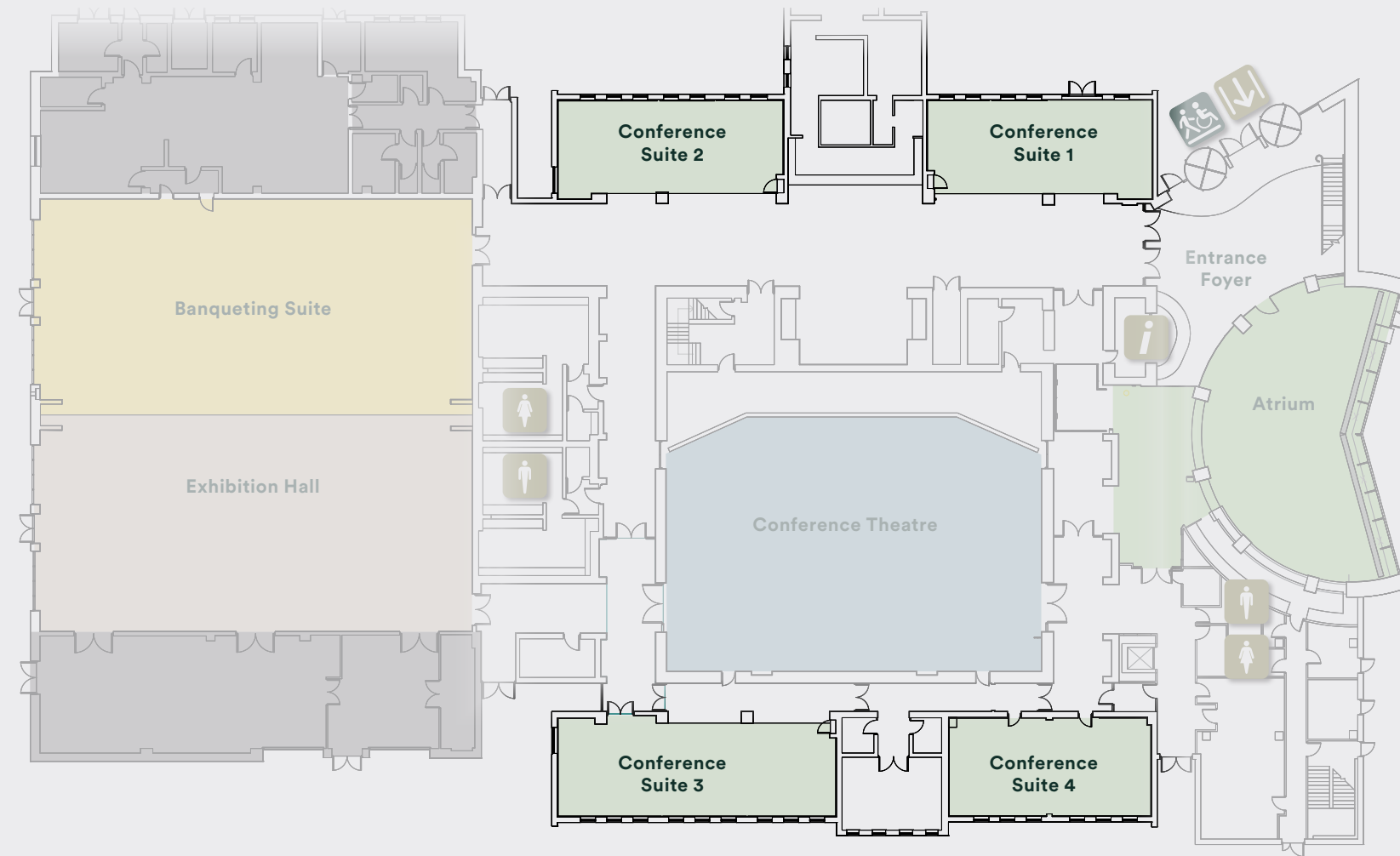

- Atrium
- Conference Suite 1,2,3 & 4
- Exhibition Hall
- Banqueting Suite
- Conference Theatre
- Restricted Areas
- Entrance
- Reception
- Toilets (Male/Female)
- Accessible Entrance

NOTTINGHAM VENUES

## CONFERENCE SUITES

Located on the lower ground floor our conference suites hold between 24-100 delegates and are perfect for training days, workshops and smaller informal meetings.

These suites are highly flexible and can be made larger or smaller using the bi-folding doors.







## GALLERY SUITES

These are a series of intimate spaces located on the first floor. The Gallery Suites can cater for seminars, launch events and workshops. They can even double up as an office space when part of a larger event.

Seating 40-60 guests in a cabaret style arrangement, the room features privacy glass and is fully self-contained.







## **HUGH STEWART MANOR HOUSE**

On the south west edge of Nottingham City centre, nestled in a woodland surrounding, stands Hugh Stewart House, a Grade II listed Gothic manor house with four elegant suites.

Completed in 1804, Hugh Stewart House was originally known as Lenton Hall from the early 19th Century until 1937.

A quick five minute drive away from The Orchard Hotel, these four grand rooms can be booked individually for a short break or for a group weekend getaway.



## TO THE MANOR BORN

Stay in our Gothic Manor House and use the striking drawing room for private meetings and get-togethers.

This location is secluded with great access to the campus facilities as well as the city centre.

The building itself has been beautifully restored and combines a modern interpretation of traditional interior design.





## THE JUBILEE HOTEL AND CONFERENCES

A unique setting for business events and overnight stays. Here contemporary interiors, natural materials and light-filled spaces combine to give a peaceful and relaxing environment for any occasion.

Close to the centre of Nottingham, The Jubilee has 100 bedrooms, a large restaurant, an auditorium and 18 versatile event spaces. The meeting rooms are perfect for team training, meetings and conferences with spectacular views over the lake. Our East and West Atriums are perfect for exhibitions, networking events and drinks receptions.





## THE JUBILEE HOTEL & CONFERENCES FLOOR PLAN

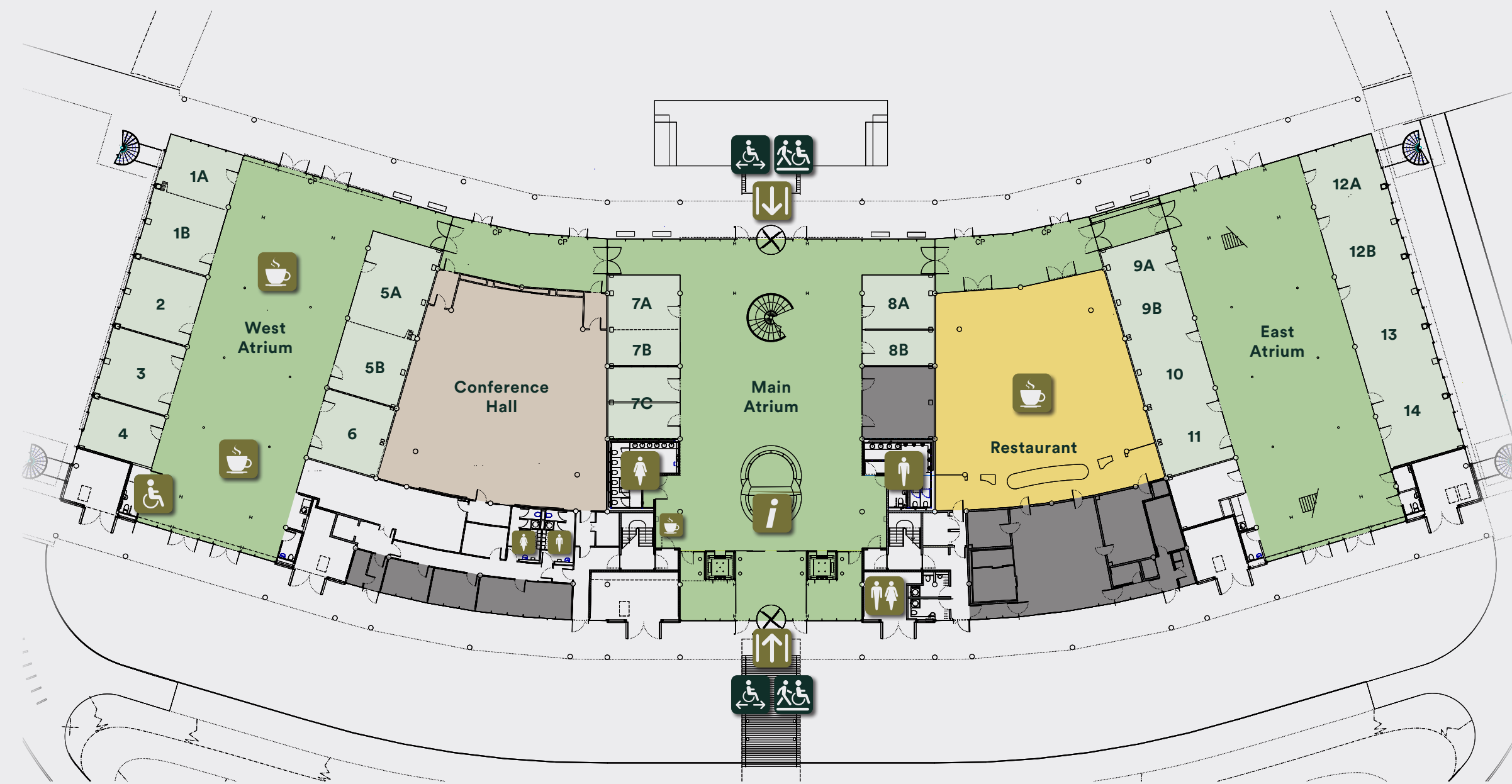

- |                 |                  |                       |                         |
|-----------------|------------------|-----------------------|-------------------------|
| Atrium          | Restaurant       | Reception             | Restaurant/Refreshments |
| Meeting Rooms   | Restricted Areas | Toilets (Male/Female) | Automatic Doors         |
| Conference Hall | Entrance         | Accessible Toilets    | Accessible Entrance     |



## EAST MEETS WEST

Home to 18 flexible and modern meeting rooms, our auditoriums can entertain up to 250 delegates in a theatre style. Both East and West Atriums have a tranquil waterside setting, home to many forms of wildlife.

Our West Atrium has eight small meeting rooms that can be booked for an event day with a buffet service in the breakout space. Our East Atrium is a similar set up with five meeting rooms and a breakout section in the middle.





# **CAMPUS VENUES CONFERENCES & ACCOMMODATION**

Our three campus locations provide an unrivalled choice of venues and facilities. At key times of the year we have over 4000 bedrooms, 40+ sports pitches and 550 meeting rooms available.

With spaces ranging from modern tiered lecture theatres and teaching laboratories, to meeting rooms, breakout spaces and exhibition halls. We are one destination with endless possibilities.





## SUM OF THE PARTS

The University of Nottingham boasts three different campuses; University Park, King's Meadow and Jubilee.

Our King's Meadow buildings specialise in film production and media, whereas University Park and Jubilee have an abundance of lecture theatres and meeting spaces.

The table opposite details the choice of spaces and the capacities available.

SPACE	MAXIMUM CAPACITY	ADDITIONAL INFORMATION
<b>UNIVERSITY PARK</b>		
Coates Road Auditorium	550	
Highfields Sports Complex	100	
Sir Clive Granger Building	210	
Law & Social Sciences Building	300	
Trent Building	180	Perfect for private dinners and celebrations
Pope Building	250	
David Ross Sports Village	3000	
Monica Partridge Building	300	Performing Arts Studio
Engineering & Science Learning Centre	150	
<b>JUBILEE CAMPUS</b>		
Exchange Building	300	
Business School South	450	Includes 2 tiered lecture theatres
<b>KING'S MEADOW</b>		
King's Meadow Studios	375	Two filming studios





## OUR EVENTS

Our infrastructure, location, facilities and hospitality team gives us the ability to host almost any event, conference or meeting.

We commonly host conferences, exhibitions, awards dinners, networking events, sporting tournaments, weddings, product launches and Christmas parties.

We are also used as a film location due to the unique make-up of our campus, its setting and its architecture.



## EVENTS TEAM

Our events team have a wealth of experience in delivering a wide range of conferences and events. They have many years experience with Nottingham Venues and know our facilities inside out.

We recognise that every event is unique which is why we put so much emphasis on understanding the purpose of the event in order to deliver the appropriate delegate experience.

Every event will have a dedicated Event Planner ensuring that the preparation is as enjoyable as the event itself.

Whether its a small meeting or a large conference, our team will provide the itinerary and manage all component parts including catering and delegate management.







## AV TEAM

We have an in-house AV team located at our East Midlands Conference Centre. This team are experts in sound and vision, with the technical ability to bring presentations, film and theatre to life.

Our team can upload bespoke signage to our digital displays and are on hand to help throughout the day.

In each space, you'll find smart intuitive technology with fast Wi-Fi and ClickShare. We can also support you in live streaming your content across different rooms or around the world.



# THANK YOU

Speak to our team to help, plan and manage your event or meeting.

**The Orchard Hotel | EMCC | Hugh Stewart House**  
0115 876 0900

**The Jubilee Hotel and Conferences**  
01159 380080

**Campus Venues**  
0115 748 6100

[events@nottinghamvenues.com](mailto:events@nottinghamvenues.com)

